

telecom

AV-1KM

FLEXIBLE MOBILE MICROPHONE

Cable Type:

In most cases, the matching cable is supplied separately from this package. Your dealer should be able to supply a ready-made cable to match your transceiver.

How to use

Set the TX/RX selector to transmit and to "R" indicator (17) should be in transmit mode. Speak about microphone and adjust suit your voice and r

If your radio has the buttons (9/10) should or channel. The act on your radio design

The CALL (13), VFO RETURN (15) and (16) have similar fu your radio (subject

Adjusting The

The gain control (1 Please adjust caref mounted on the circ operator to listen to the ALC reading in t much gain can caus

RF Feedback.

If you run high power the microphone cab VSWR is low. If any where the mic. Cab ring near the point v out these suggestio transceiver microph

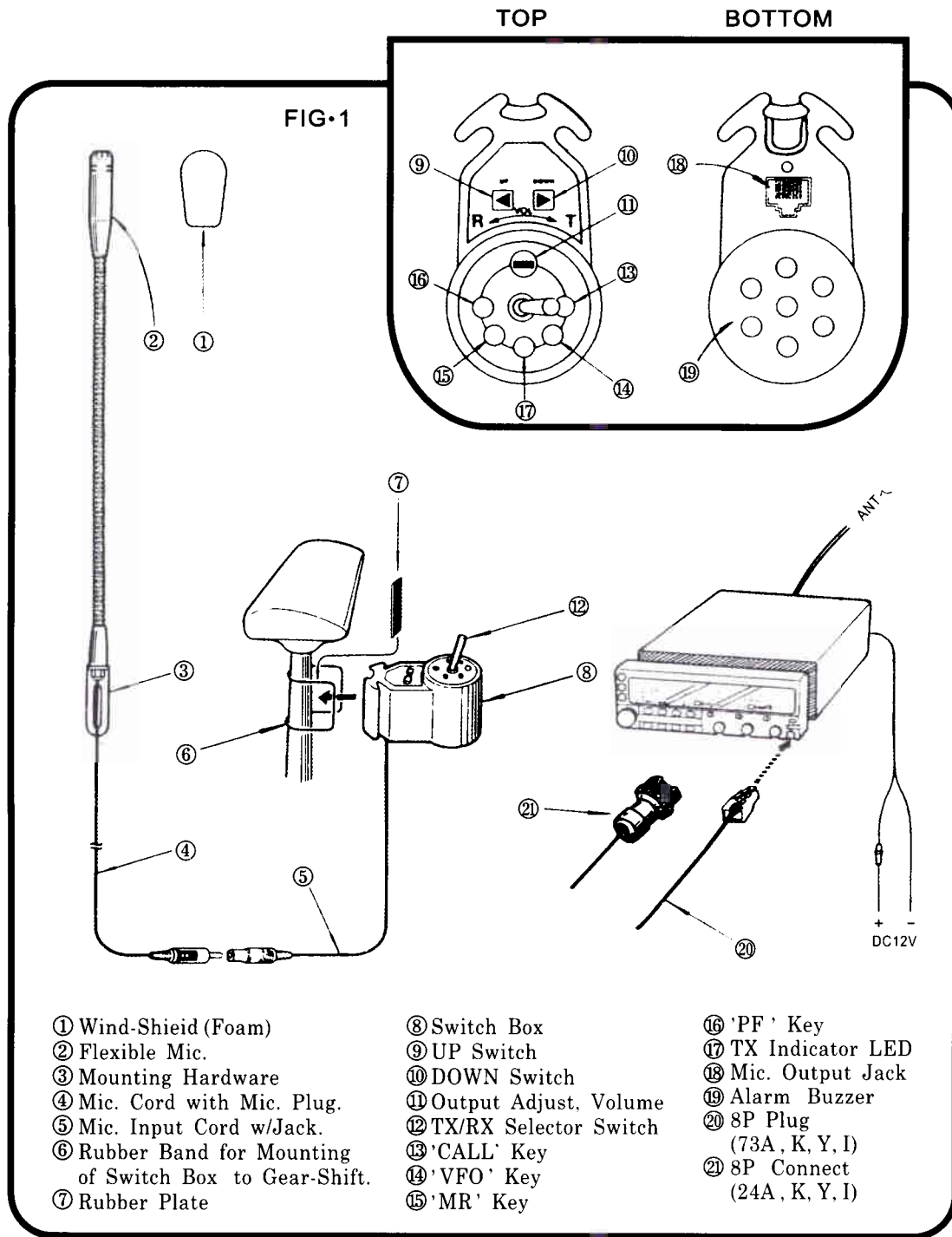

How to Mount and Install the AV-1KM

Fasten the doose neck boom (3) under the car sun viso by using the car`s existing screw or bolt. We recommend the position to the right of the driver.

Attach the wind-shield (1) to reduce noise.

The PTT box (8) is attached to the gear change with a rubber band (6). Observe the way the band is formed into two fastenings.

Connect the microphone cord (4) to jack (5). Then connect the appropriate mic.

How to use

Set the TX/RX selector (12) to "T" for transmit and to "R" for receive. The LED indicator (17) should light up when in "T" mode. Speak about 10cm from the microphone and adjust mic. gain (11) to suit your voice and radio.

If your radio has the feature, the up/down buttons (9/10) should change frequency or channel. The actual operation depends on your radio design.

The CALL (13), VFO (14), MEMORY RETURN (15) and PRIORITY FUNCTION (16) have similar functions to those on your radio (subject to your radio's design).

Adjusting The Microphone Gain

The gain control (11) is quite critical. Please adjust carefully as it is directly mounted on the circuit board. Get another operator to listen to your audio or watch the ALC reading in the case of SSB. Too much gain can cause distortion !

RF Feedback.

If you run high power, you could have problems with RF feedback. Make sure that the microphone cable does not run near the antenna cable and make sure the VSWR is low. If any problem persists, then try placing a ferrite ring at the point where the mic. Cable enters the base of the PTT box. In bad cases, also try a ferrite ring near the point where the mic. Cable enters your transceiver. Before carrying out these suggestions, do check that there is no RF feedback with the normal transceiver microphone. If there is, then consult your dealer.

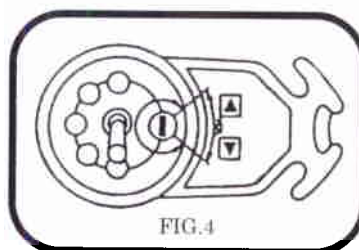
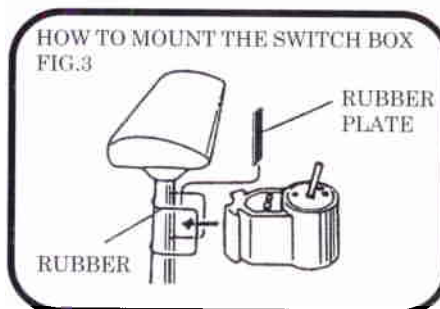
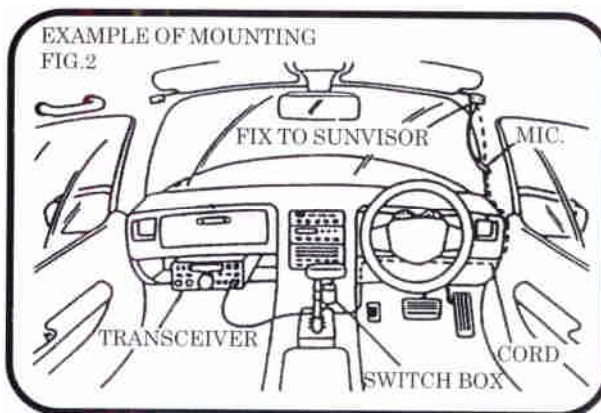

MOBILE MICROPHONE

FEATURES:

- Microphone mounts onto the sun visor for tidy installation
- PTT box mounts on the gear change lever
- DC power is taken from the microphone socket of your radio
- Additional up/down functions are available on PTT box
- Hands-free operation with latching PTT
- Adjustable microphone gain control
- Quick Change leads for different radio models

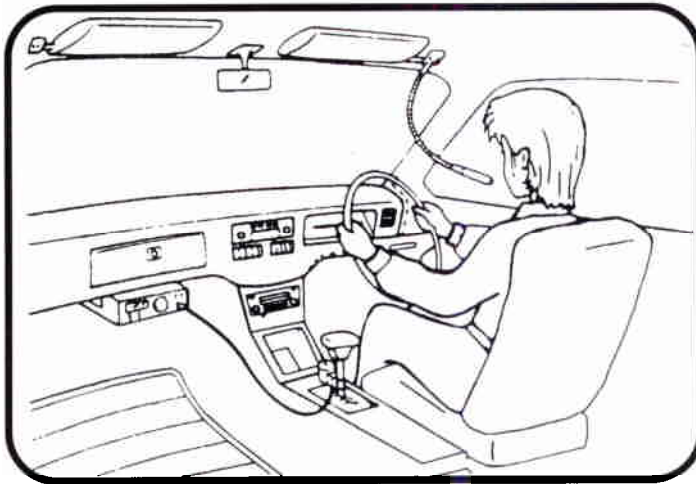

AV-1KM SPECIFICATIONS:

Mic Section:

- Uni-Directional Condensor Mic..... 1
- Flexible Goose Neck..... 230mm x 8 \varnothing
- Mic Cord..... 3m

Control Section:

- IC..... 1
- TR..... 2
- Diode..... 5
- Switch..... 8
- Output Cord..... 1.5m
- Size..... 54(h)x33(w)x69(d)mm

CAUTION:

The microphone mounts under the bulkhead bolt of the sun visor. Please make sure it is firmly attached and cable is safely routed. Please also make sure that the microphone is angled so it does not interfere with your forward vision.